

# Katampe View Terraces

a fusion of comfort,  
beauty, luxury, privacy  
and sustainability

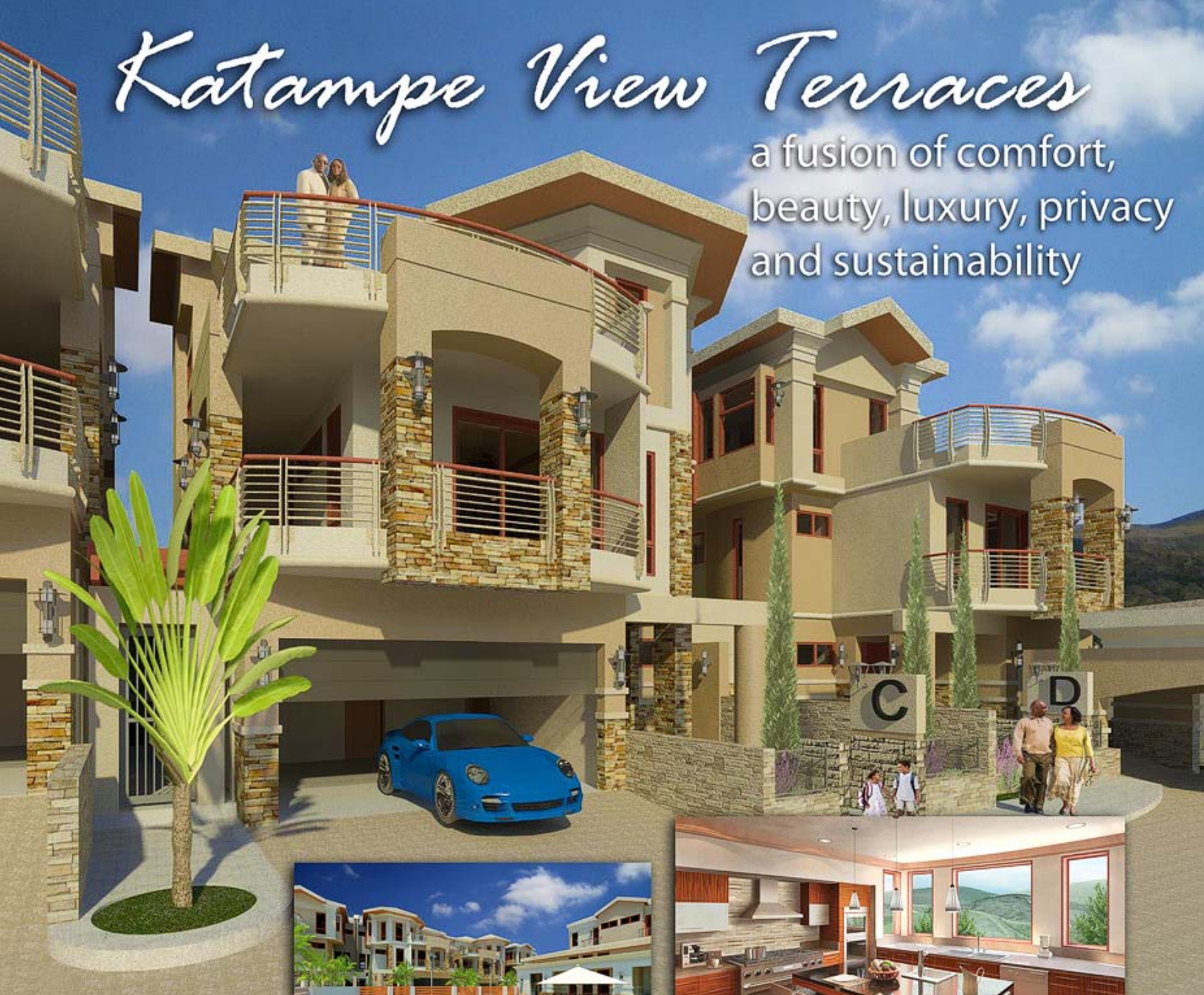

Situated within 40-minutes from Nnamdi Azikiwe International Airport, Katampe View Terraces, a uniquely designed cluster of townhomes, is located in a prominent serene environment within Katampe Extension District in Abuja. Katampe Extension District is a "Diplomatic Zone" with ongoing development within an area served by ample infrastructure. The residential development is located within a gated secured complex and consists of 5 luxury homes of 4-bedroom 2-storey residences with 1-bedroom BQ. All rooms are en-suite and have been designed with utmost attention to details for the most demanding clients.

Visit our website for additional information

[www.katampeviewterraces.com](http://www.katampeviewterraces.com)

# Katampe View Terraces



**SECOND FLOOR** Master Bedroom - Master Living Balcony  
Master Bath - Master Living Room - Terrace - Bedroom 2 - Bath 2



**FIRST FLOOR** Living Room - Dining Room - Powder Room - Bedroom 1 - Bath 1 - Kitchen - Balconies



**GROUND FLOOR** Guest Suite - Guest Bath - Family Lounge - Powder Room - BQ's Bedroom & Bath - BQ's Kitchen Laundry Room - Attached Garage

## UNIT D

Four Bedrooms with attached one-car garage and one-bedroom BQ

Living Area: 428.05 sq.m. (4,607 sq. ft.)

Balconies: 67.41 sq.m. (725 sq. ft.)

Garage: 24.59 sq.m. (265 sq. ft.)



**SITE PLAN**

## UNIT AMENITIES

- Contemporary fitted kitchen
- Two large living rooms and a family room
- All bedrooms en suite
- En suite servant's quarters
- Large terraces and balconies
- Exclusive penthouse master suite
- Private entry courtyard
- Enclosed garage

## COMMUNITY AMENITIES

- Perimeter fence with CCTV
- Swimming pool
- Fitness Center - Gym
- Ample visitor's parking
- Alternate power provided by 2 generators
- Alternate water