

Katampe View Terraces

a fusion of comfort,
beauty, luxury, privacy
and sustainability

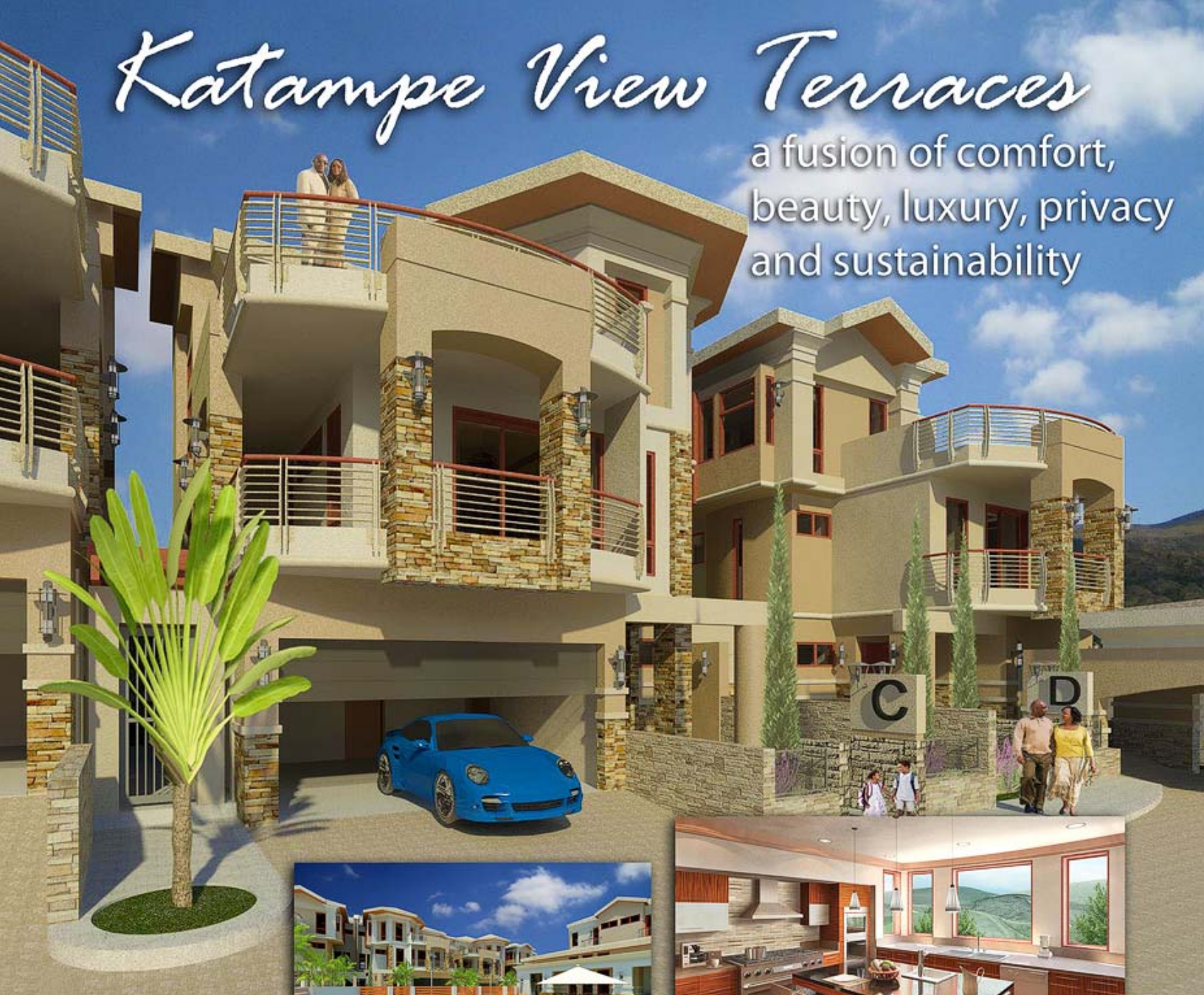

Situated within 40-minutes from Nnamdi Azikiwe International Airport, Katampe View Terraces, a uniquely designed cluster of townhomes, is located in a prominent serene environment within Katampe Extension District in Abuja. Katampe Extension District is a "Diplomatic Zone" with ongoing development within an area served by ample infrastructure. The residential development is located within a gated secured complex and consists of 5 luxury homes of 4-bedroom 2-storey residences with 1-bedroom BQ. All rooms are en-suite and have been designed with utmost attention to details for the most demanding clients.

Visit our website for additional information

www.katampeviewterraces.com

Katampe View Terraces



SECOND FLOOR Master Bedroom - Master Balcony
Master Bath - Master Living Room - Terrace - Bedroom 2
Bath 2



FIRST FLOOR Living Room - Dining Room - Powder
Room - Bedroom 1 - Bath 1 - Kitchen - Balconies



GROUND FLOOR Guest Suite - Guest Bath - Family
Lounge - Powder Room - BQ's Bedroom & Bath - BQ's Kitchen
Laundry Room - Attached Garage

UNIT C

Four Bedrooms with attached two-car
garage and one-bedroom BQ

Living Area: 429.53 sq.m. (4,697 sq. ft.)

Balconies: 72.16 sq.m. (776 sq. ft.)

Garage: 35.90 sq.m. (386 sq. ft.)



SITE PLAN

UNIT AMENITIES

- Contemporary fitted kitchen
- Two large living rooms and a family room
- All bedrooms en suite
- En suite servant's quarters
- Large terraces and balconies
- Exclusive penthouse master suite
- Private entry courtyard
- Enclosed garage

COMMUNITY AMENITIES

- Perimeter fence with CCTV
- Swimming pool
- Fitness Center - Gym
- Ample visitor's parking
- Alternate power provided by 2 generators
- Alternate water